

SPECIFICATIONS



Model: 3CW

All stainless steel, bi-metal operated, dial thermometer with sealed head.

- CASE** AISI 304 stainless steel
- BEZEL** AISI 304 stainless steel
- DIAMETER** 63 mm
- STEM** Stainless steel, welded construction
 - 6.35 mm diameter
 - Lengths from 50 mm to 300 mm in AISI 316 stainless steel
- CONNECTION** Fixed Thread, Adjustable compression union or seperable pocket (thermowell), all in 316 stainless steel
- THREAD** Fixed thread ½ " NPT, Unions ½ " NPT. Pockets ½ " NPT. (Other sizes available on request.)
- RANGES** From -40 to 250 °C. Refer standard ranges list
- ACCURACY** ±1 % of full scale
- WINDOW** Polycarbonate
- GASKET** Nitrile

FEATURES

- May be mounted in vertical or horizontal positions
- Head may be silicone filled for heavy duty plant conditions. Accuracy may be reduced if liquid filled
- Rust and corrosion proof, leak sealed heads

OPTIONS

- Back flange for duct mounting
- Customised dial markings, e.g. logos, sectors, other temperature units

STANDARD RANGES

Standard Ranges °C	Scale Divisions
-40/60	2 °C
-20/80	1 °C
0/50	1 °C
0/100	2 °C
0/120	2 °C
0/150	2 °C
0/200	2 °C
0/250	5 °C

DIMENSIONS (mm)

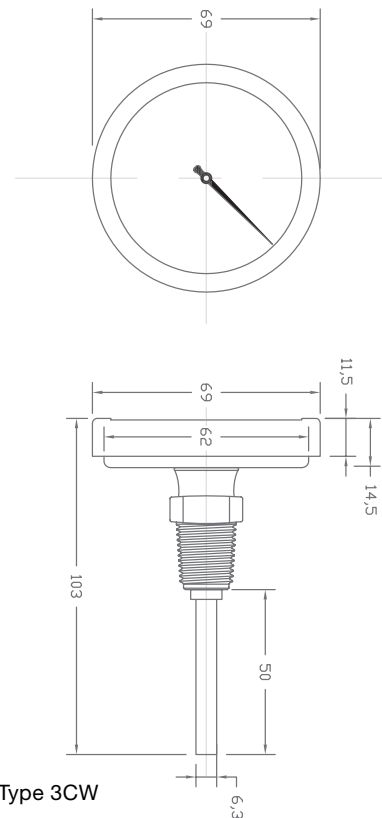

Type 3CW

ORDERING GUIDE

Model ----- **3CW** **0/120** **300** **T** **½ " NPT** **L** --- Liquid Filled

Temperature Range ----- Thread Form

Length of Stem ----- Connection Type
 F - Fixed stainless steel union
 C - Compression union
 T - Thermowell

Manufactured in New Zealand by
TELTERM INSTRUMENTS LTD.
 5/343 Church St,
 Onehunga
 Auckland 1061

P.O. Box 12-171,
 Penrose
 Auckland 1642

Ph: +64 9 633 0040
Fax: +64 9 633 0012
Email: sales@teltherm.co.nz
www.teltherm.co.nz